

A fastener specifically designed for the commercial vehicle body building industry where G.R.P. (glass reinforced plastic) boards are used. This fastener covers a wide grip range, is T.I.R. approved, gives improved security to commercial vehicles and has excellent cosmetic appearance qualities.

High Uniform Installed Values

Gives the uniform clamp required every time without dimpling side panels.

Fast And Easy Installation

Does not require highly skilled labour, reduces rework and error.

Plastic Coloured Heads (Optional)

Encapsulated heads can be colour co-ordinated to your side panel colouring.

Low Profile Head Design

Does not bulge or protrude, gives good "cosmetic" appearance to vehicles.

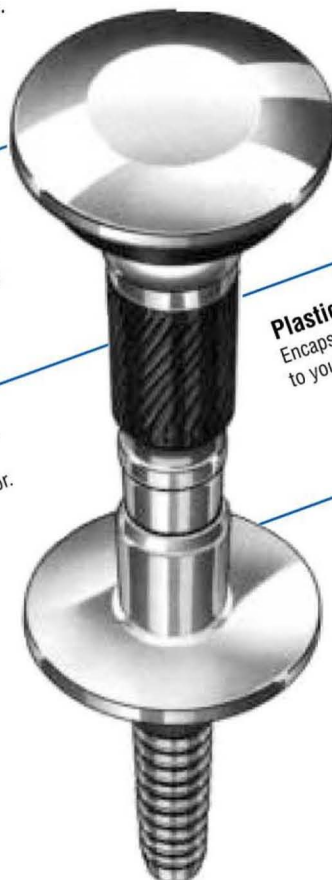

APPLICATIONS

- Commercial vehicle body building.
- Suitable for use on rubber swing doors and in the construction of G.R.P. board type products.



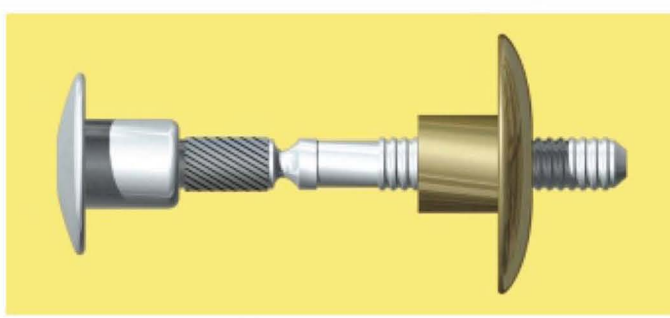

Standard low profile head

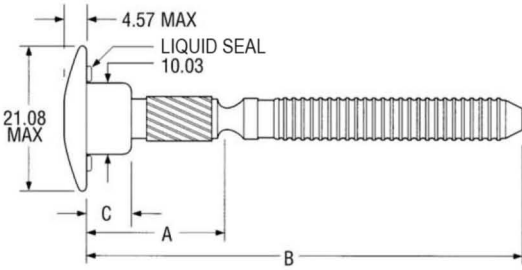

Plastic encapsulated head

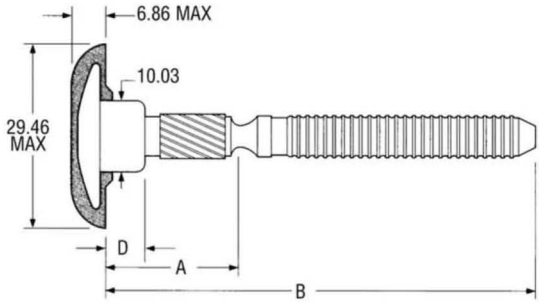

Part No. Standard	Part No. Encapsulated	Grip range* min - max	A ± 0.25	B $\pm 1.52-0.0$	C	D
HLPPLS-R12-10	HLPE(**)-R12-10	14.27 - 17.48	15.85	56.69	2.54	0.97
HLPPLS-R12-11	HLPE(**)-R12-11	15.88 - 19.05	17.45	58.29	4.01	2.44
HLPPLS-R12-12	HLPE(**)-R12-12	17.45 - 20.62	19.02	59.87	5.59	4.01
HLPPLS-R12-13	HLPE(**)-R12-13	19.05 - 22.23	20.62	61.47	7.16	5.59
HLPPLS-R12-14	HLPE(**)-R12-14	20.62 - 23.80	22.20	63.04	8.76	7.19
HLPPLS-R12-15	HLPE(**)-R12-15	22.23 - 25.40	23.80	64.64	10.36	8.79
HLPPLS-R12-16	HLPE(**)-R12-16	23.80 - 26.97	25.37	66.22	11.94	10.36
HLPPLS-R12-17	HLPE(**)-R12-17	25.40 - 28.58	26.97	67.82	13.51	11.94
HLPPLS-R12-18	HLPE(**)-R12-18	26.97 - 30.15	28.55	69.39	15.11	13.54
HLPPLS-R12-19	HLPE(**)-R12-19	28.58 - 31.75	30.15	70.99	16.71	15.14
HLPPLS-R12-20	HLPE(**)-R12-20	30.15 - 33.32	31.72	72.57	18.29	16.71
HLPPLS-R12-21	HLPE(**)-R12-21	31.75 - 34.93	33.32	74.17	19.86	18.29
HLPPLS-R12-22	HLPE(**)-R12-22	33.32 - 36.50	34.90	75.74	19.86	18.29

* Other grip ranges are available. Please call your Huck representative.
** Add encapsulated colour: W = white, G = grey, Y = yellow. Consult Huck for other colours.

Typical Installed Tensile in Nominal Grip (N)

Diameter	Tensile
10.03	6670 typ

Materials and Finishes

	Material	Finish
Sleeve	Steel	Zinc Plated Gold Chromate
Pin	Steel	Zinc Plated Clear Chromate

Recommended Hole Size

Diameter	Hole Size
10.03	10.29 - 10.69

Wide bearing sleeve HLPS-R12

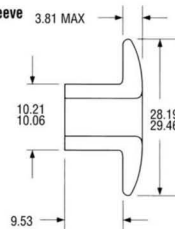

Clearance sleeve¹ HLPSC-R12

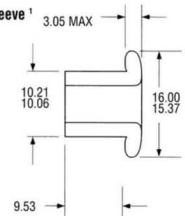

Flat sleeve HLPS-R12XA

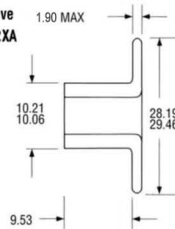

Medium sleeve HLPSP-R12

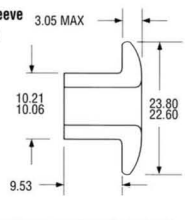

¹ Clearance sleeves are for use against metal structure only.

Recommended Installation Configurations



HLPP-R12-() & HLPSC-R12

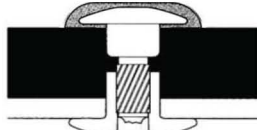

HLPE(**)-R12-() & HLPSC-R12

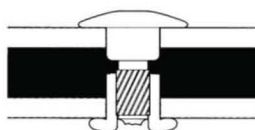

HLPP-R12-() & HLPSC-R12

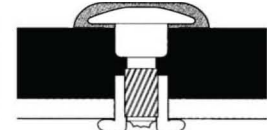

HLPE(**)-R12-() & HLPSC-R12

Aluminium, Steel, Etc.

FRP or other clamp sensitive material

Huck Installation Tools

Huck installation tools consist of a nose assembly and a tool. The choice of tool and nose assembly is determined by the fastener diameter and application.

Tools and nose assemblies are easily changed as installation requirements demand. Huck offers pneumatic and hydraulic installation tools. Pneumatic tools operate on 6.2-6.9 bar (90-100 psi) air pressure. The lighter weight hydraulic tools operate on hydraulic power supplied by a Huck POWERIG® Hydraulic Unit.

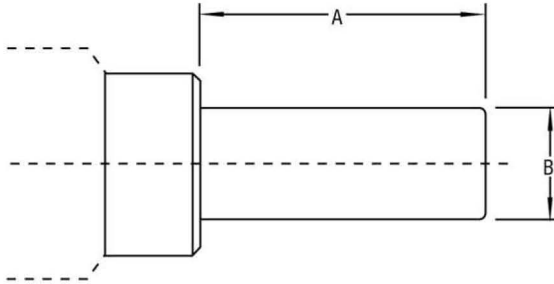

Nose Ass.	A mm	B mm	Pneumatic Tooling	Hydraulic Tooling
99-3464	77.7 (3.1/16")	28.2 (1.11")	2025	2480
99-3464L	77.7 (3.1/16")	28.2 (1.11")	2025L	2480L
99-3438	68.9 (2.23/32")	27.7 (1.3/32")	245 / 246 / 255 / 256	2503 / 2580

Items in **bold** are part of our FOCUS Tooling Range

Note: Other tool and nose assembly combinations may be available for specific applications. Please contact Huck for details.

Installation Sequence

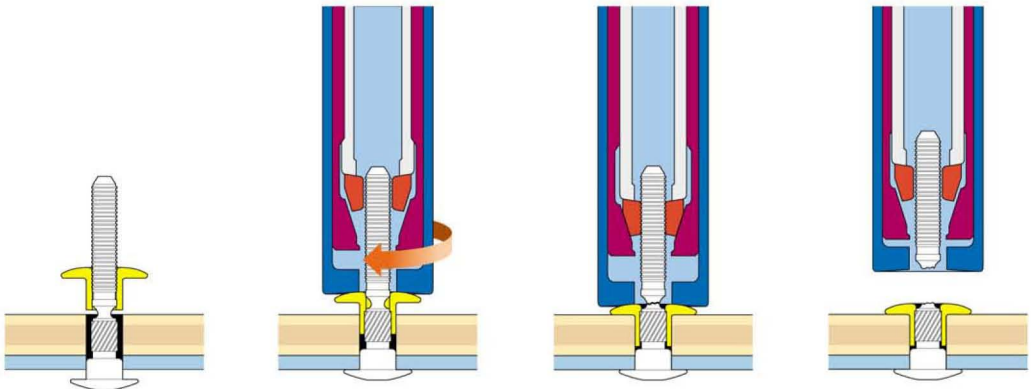

Whilst every care has been taken to ensure the accuracy of the above information, Star Fasteners (UK) Limited cannot accept responsibility for any errors or omissions.